

4

3

2

1

THIS DRAWING IS UNPUBLISHED. RELEASED FOR PUBLICATION
 BY AMP INCORPORATED. ALL RIGHTS RESERVED.

LOC	DIST	REVISIONS					
		P	LTR	DESCRIPTION	DATE	DWN	APVD
G	86	F		REV PER 063A-0485-01	21AUG01	JR	MS

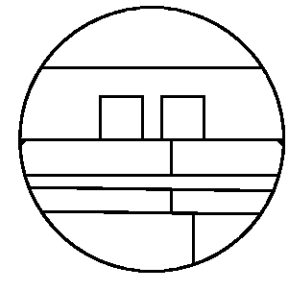
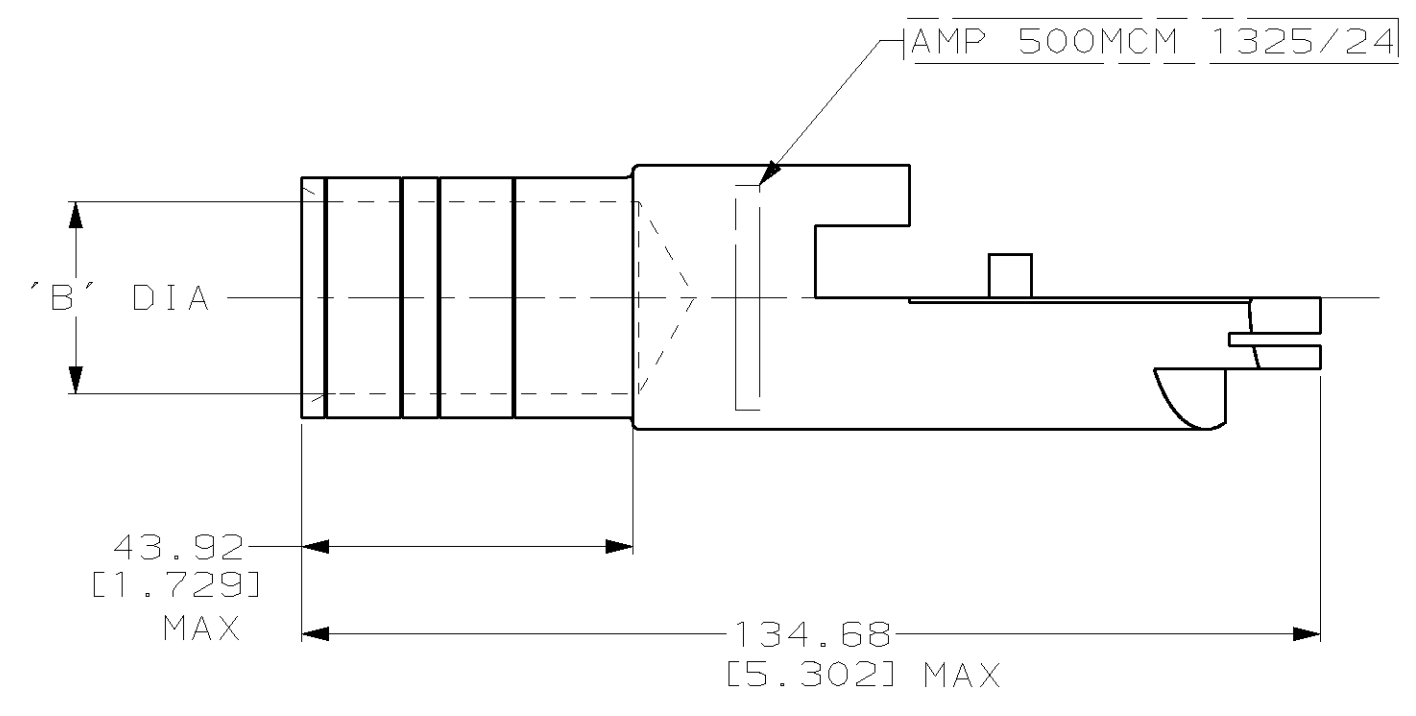
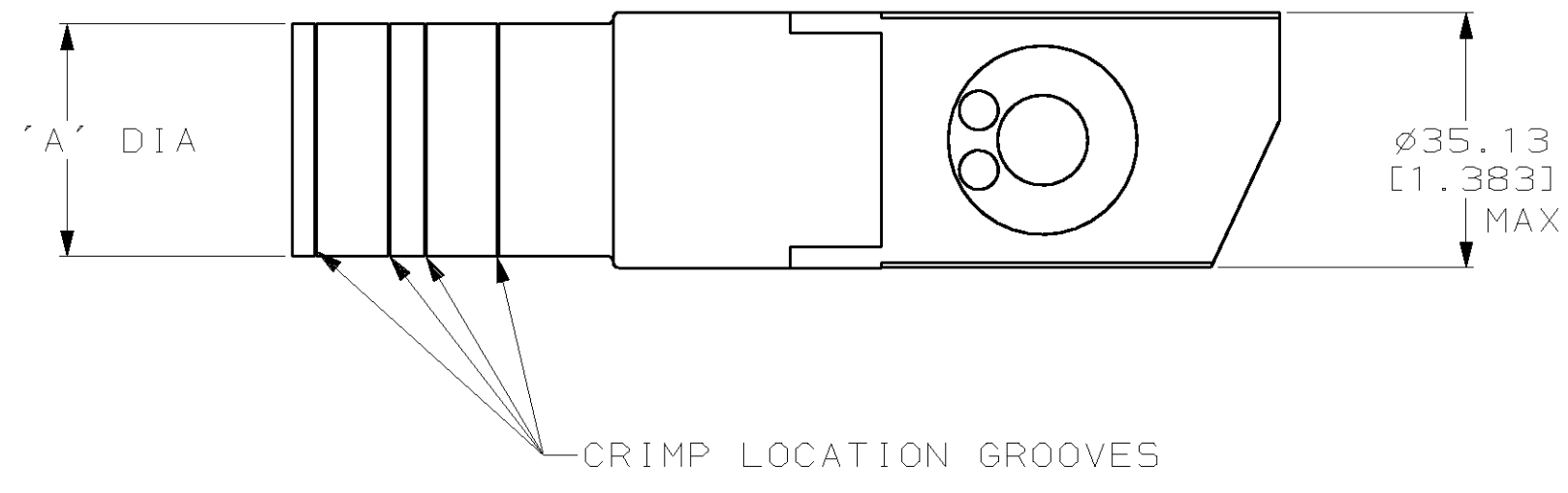

26.92-26.67 [1.060-1.050]	33.66-33.40 [1.325-1.315]	53435-2
25.53-25.40 [1.005-1.000]	32.00-31.75 [1.260-1.250]	53435-1
'B'	'A'	AMP PART NUMBER

THIS DRAWING IS A CONTROLLED DOCUMENT FOR AMP INCORPORATED. IT IS SUBJECT TO CHANGE AND THE CONTROLLING ENGINEERING ORGANIZATION SHOULD BE CONTACTED FOR THE LATEST REVISION.		DWN DK SCHRUM 17JUN96	AMP Incorporated Harrisburg, PA 17105-3608
DIMENSIONS: mm [INCHES]		CHK WJ VOCKROTH 25JUN96	
TOLERANCES UNLESS OTHERWISE SPECIFIED: 0 PLC ± 1 PLC ± 2 PLC ±0.20 [0.008] 3 PLC ± 4 PLC ± ANGLES ±		APVD JL MECKLEY 25JUN96	NAME TERMINAL ASSEMBLY, QUICK-DISCONNECT, AMPOWER, WIRE SIZE: 500 MCM
MATERIAL BODY & PINS BRASS PER 00-B-626		FINISH SILVER PL 0.00127 [0.00050] MIN THK PER 00-S-365	PRODUCT SPEC 108-13014 APPLICATION SPEC - WEIGHT - lbs SCALE 1:1
		CUSTOMER DRAWING	DRAWING NO C-53435 SHEET 1 OF 1 REV F

53435

00

A